

RACO

The Modular Actuator System

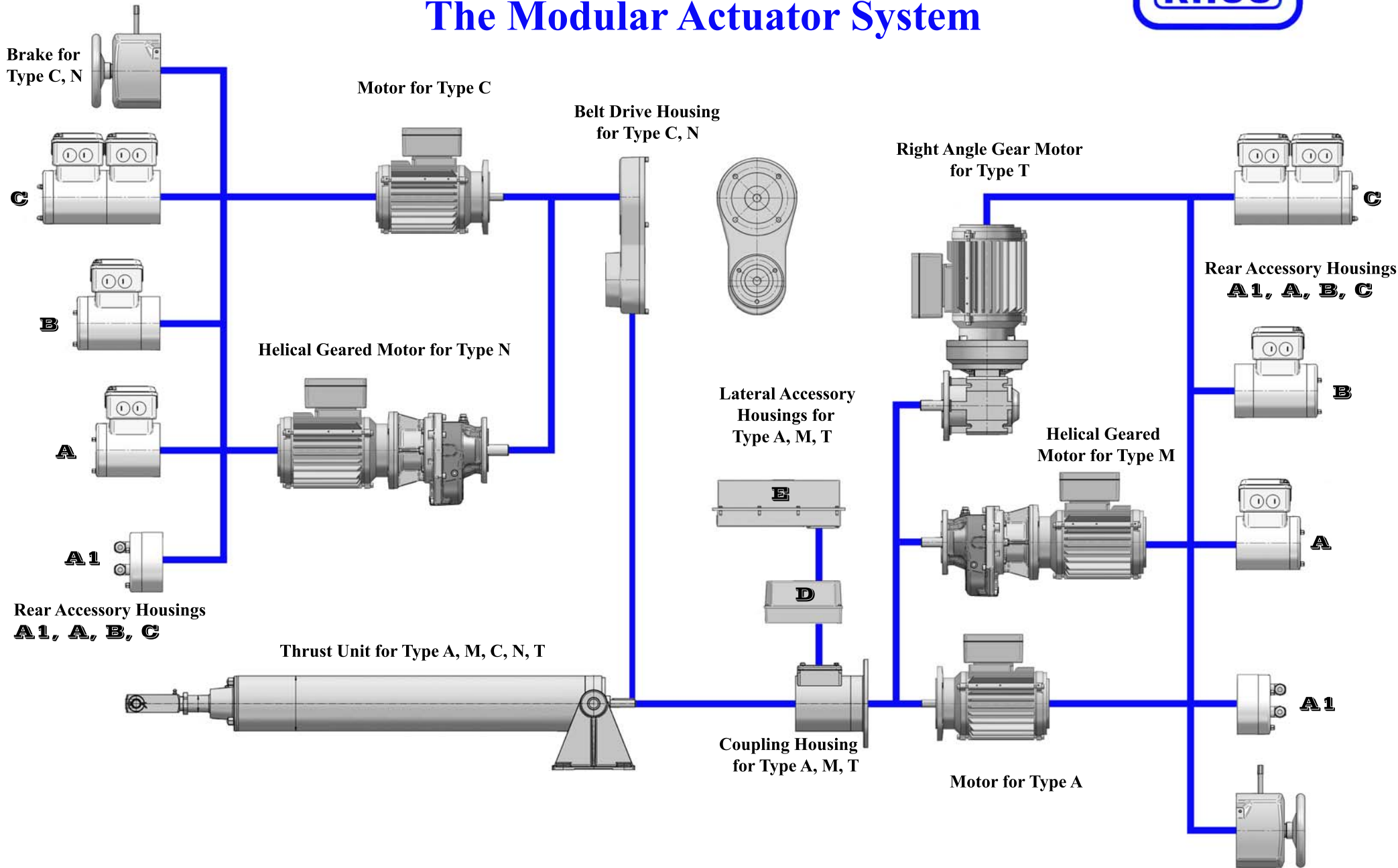

RACO Electrical Actuator Universal Design Combinations
The Heavy Duty Series Smart Solution

RACO ACTUATOR DIMENSIONS

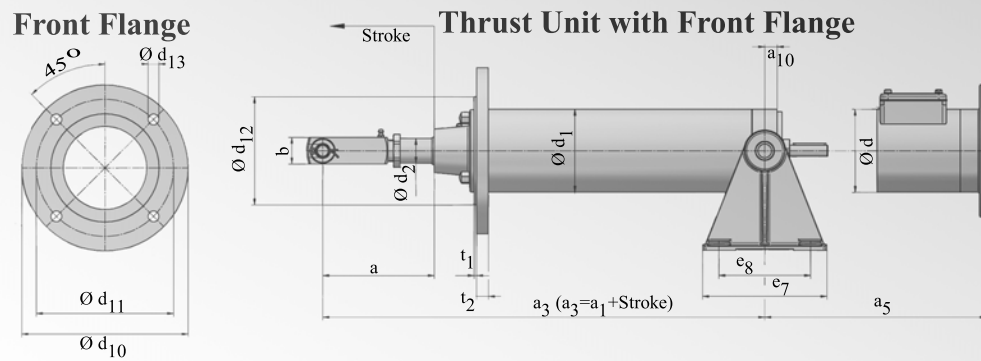
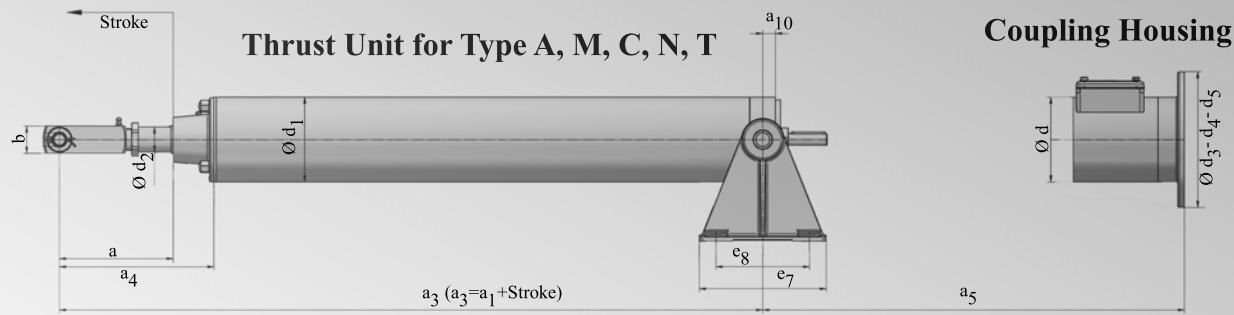

Motor for Type A & C

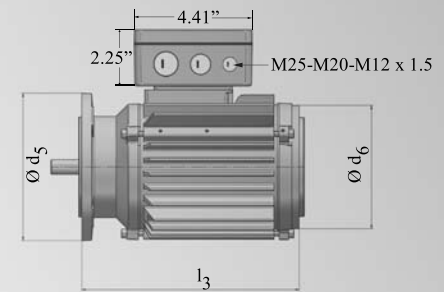

Helical Gear Motor for Type M & N

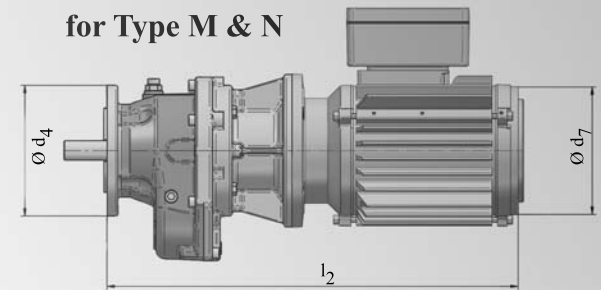

Right Angle Gear Motor for Type T

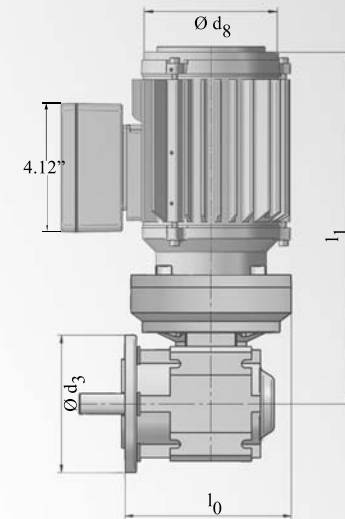

Trunnion Brackets

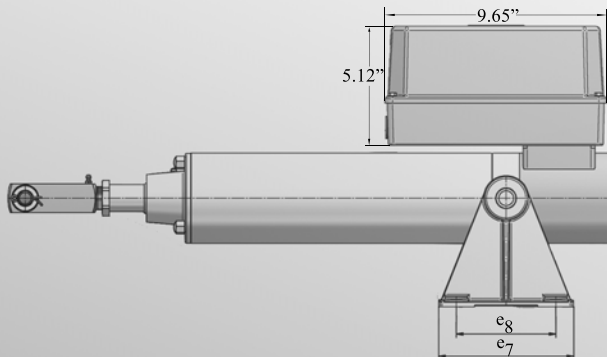

Trunnion Pins

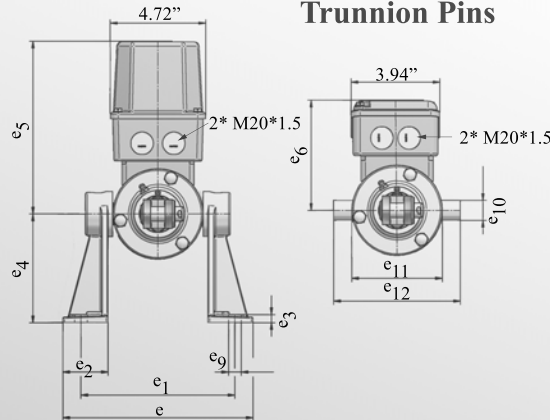

RACO ACTUATOR DIMENSIONS

Belt Drive Housing for Type C, N

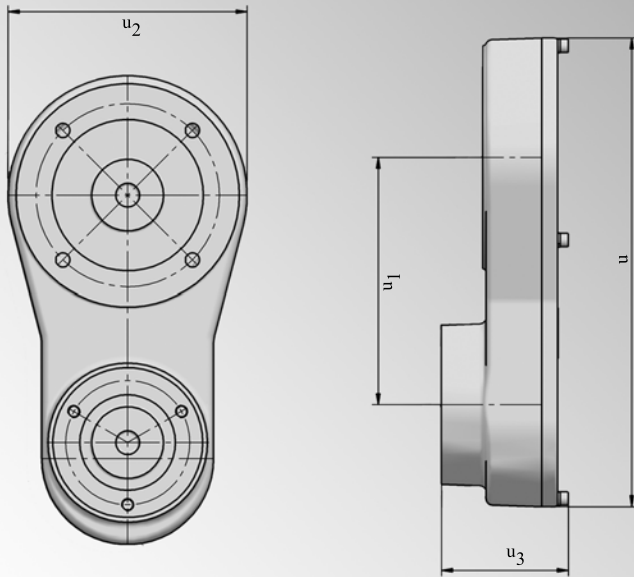

Rear Accessory Housings Type **A1, A, B, C**

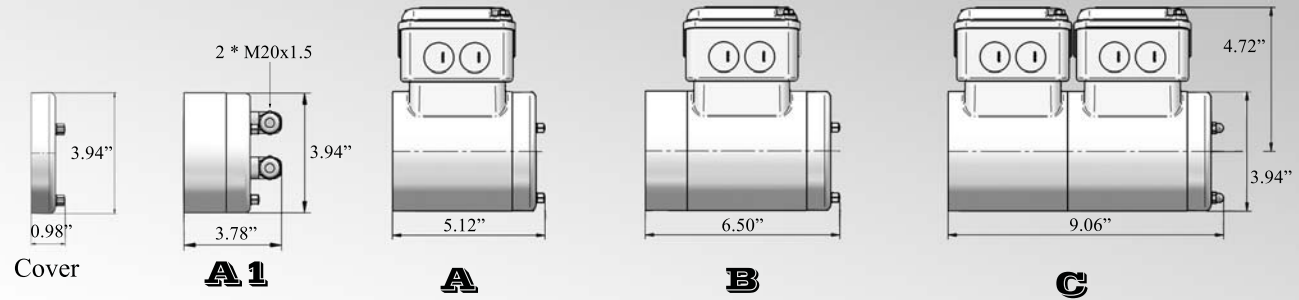

Lateral Accessory Housings **D, E**

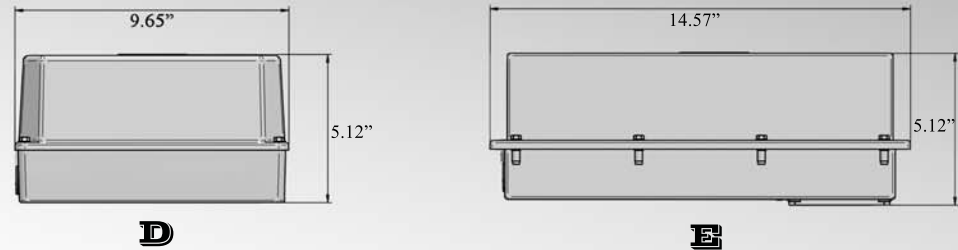

Front Clevis & Rod Eye

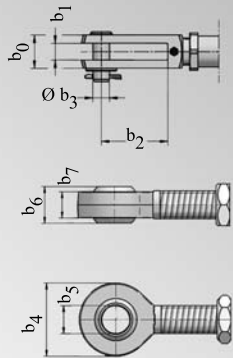

Brake for Type A, M, C, N, T

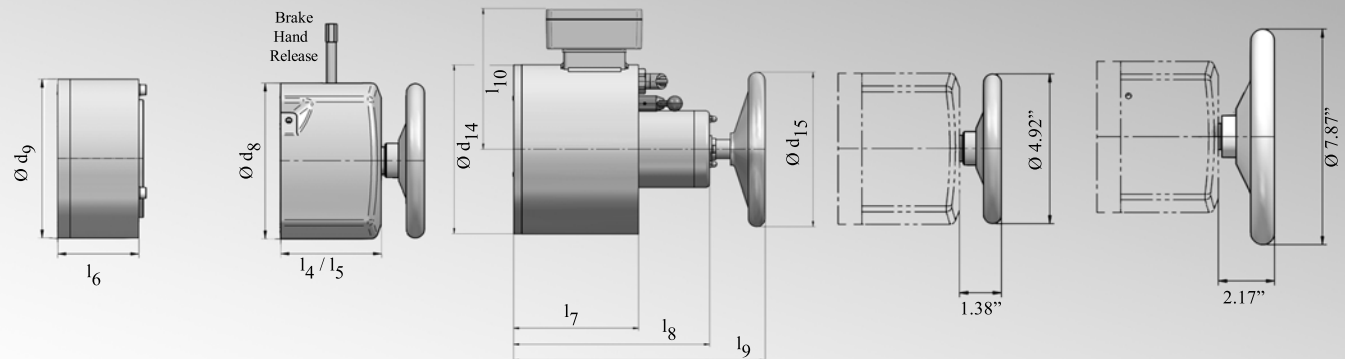

RACO

The Modular Actuator System



Dimensions (inch)

Size	Actuator Length						Front Clevis / Spherical Rod Eye							Diameter / Diameter Motor										Front Flange Mounting								
	a	a ₁	a ₃	a ₄	a ₅	a ₁₀	b	b ₀	b ₁	b ₂	b ₃	b ₄	b ₅	b ₆	b ₇	d	d ₁	d ₂	d _{3max}	d _{4max}	d _{5max}	d _{6max}	d _{7max}	d ₈	d ₉	d ₁₀	d ₁₁	d ₁₂	d ₁₃	t ₁	t ₂	
4	5.20	12.99	a ₁ + Stroke	6.42	5.31	0.59	1.26	1.26	0.63	2.52	0.63	1.65	0.63	0.83	0.59	3.94	3.94	1.18	4.72	4.72	5.51	5.43	4.80	4.92	5.00	7.87	6.50	5.12	4*0.43	0.12	0.55	
5	4.84	13.98	a ₁ + Stroke	6.38	5.91	0.71	1.57	1.57	0.79	1.57	0.79	2.52	0.98	0.79	0.67	6.73	4.49	1.57	6.30	6.30	7.87	6.10	4.80	6.22	6.73	7.87	6.50	5.12	4*0.51	0.12	0.59	
6	7.09	18.50	a ₁ + Stroke	8.74	6.30	1.06	2.20	2.20	1.10	2.20	1.10	2.87	1.18	0.87	0.75	6.73	5.51	1.97	7.87	6.30	7.87	7.72	6.10	7.72	8.62	9.84	8.46	7.09	4*0.51	0.16	0.63	
7	6.26	21.46	a ₁ + Stroke	7.68	8.86	1.89	3.15	3.15	1.26	2.36	1.57	4.57	1.97	1.38	1.57	7.01	7.09	2.36	7.87	6.30	7.87	7.72	7.72	7.72	8.62	11.81	10.43	9.06	8*0.55	0.16	0.79	
8	7.56	22.83	a ₁ + Stroke	9.02	10.24	3.54						4.57	1.97	1.38	1.57	7.87	8.66	3.94	9.84	9.84			7.72	7.72	8.62	13.78	11.81	9.84	8*0.71	0.20	0.79	
9	8.46	26.77	a ₁ + Stroke	17.72								6.30	2.76	2.17		For Gear-Motor Size Information Consult																
10	15.35	35.83	a ₁ + Stroke	25.00								8.82	3.94	2.76		your Sales Representative																
11	14.57	41.34	a ₁ + Stroke	28.35								10.43	4.33	3.15																		

Size	Trunnion Brackets														Motor / Gearbox				Brake Handwheel & Mech. Dis.						Drive Housing												
	e	e _{1 inner}	e ₁	e ₂	e ₃	e ₄	e ₅	e ₆	e ₇	e _{8 inner}	e ₈	e ₉	e ₁₀	e ₁₁	e ₁₂	l ₀	l ₁	l ₂	l ₃	l ₄	l ₅	l ₆	l ₇	l ₈	l ₉	l ₁₀	d ₁₄	d ₁₅	u	u ₁	u ₂	u ₃					
4	8.27		6.69	1.97	0.35	4.72	7.48	4.72	5.91		4.33	0.55	0.87	3.94	5.51	5.71	11.08	13.78	8.19	3.23	3.23	2.48	4.76	8.11	10.94	6.24	6.73	6.30	11.57	6.10	5.91	2.87					
5	11.22		9.65	1.97	0.35	4.72	8.78	5.98	5.91		4.33	0.55	1.18	6.89	9.25	6.10	12.19	14.80	8.46	4.13	5.04	3.98	4.76	8.11	10.94	6.24	6.73	6.30	15.94	7.87	8.27	4.57					
6	12.80		10.43	2.76	0.47	6.30	8.78	5.98	10.24		7.87	0.71	1.57	6.89	10.04	7.64	12.76	15.16	11.77	4.84	6.42	4.84	6.38	9.72	12.60	7.36	8.66	7.09	15.94	7.87	8.27	4.57					
7	13.78		11.42	2.76	0.47	6.30	8.78	5.98	10.24		7.87	0.71	1.57	7.87	11.10	7.64	17.68	21.57	11.77	4.84	6.42	5.12	6.38	9.72	12.60	7.36	8.66	7.09	15.94	7.87	8.27	4.57					
8	16.34		13.98	3.15	0.47	7.87	9.84	7.09	9.45	3.94	7.09	0.71	1.97	9.65	13.58	9.53	22.83	22.60	11.77	4.84	6.42	4.84	6.38	9.72	12.60	7.36	8.66	7.09	22.83	13.50	8.27	6.10					
9	21.65	11.81	19.69	5.91	0.71	10.24	25.31		12.60		10.59	0.63	2.76	12.99	18.50	Included in				Included in												Flat Gear Drive					
10	27.56	15.75	25.20	7.09	0.91	11.81	45.98		15.75		12.60	1.02	3.94	16.54	24.41	Gear Motor				Gear Motor													Housings are Available				
11	30.71	17.32	28.35	7.87	1.30	13.78	49.21		20.47		16.54	1.02	3.94	18.11	27.56	Dimension				Dimension														on Request			

Type	Standard Stroke Increments in inches																			
T1A4/T1A5	3.9	7.9	11.8	15.7	19.7	23.6	31.5	39.4												
T1A6/T1A7		7.9		15.7		23.6	31.5	39.4	47.2	55.1	63.0	70.9	78.7							
T1M8/T1T8		7.9		15.7		23.6	31.5	39.4	47.2	55.1	63.0	70.9	78.7							
K1T9				15.7		23.6	31.5	39.4	47.2	55.1	63.0	70.9	78.7	86.6	102.4	118.1				
K1T10						23.6	31.5	39.4	47.2	55.1	63.0	70.9	78.7	86.6	102.4	118.1	137.8	157.5		
K1T11						23.6	31.5	39.4	47.2	55.1	63.0	70.9	78.7	86.6	102.4	118.1	137.8	157.5	196.9	236.2

Weights of Actuator & Accessories

Stroke (inch)	3.9	7.9	11.8	15.7	19.7	23.6	31.5	39.4	47.2	55.1	63.0	70.9	78.7	98.4	Trunnion Brakets	Motor Brake	A	B	C	D	E	
Type	Weight in lb.															Rear Accessory Housing						
Y4	13	15	17.6	19.8	22	24.2	28.6	33							2.6					4.4	11	
A4	31	33	35.2	37.4	39.6	41.8	46.2	50.6							2.6	4.4	4.4	5.5	7.7	4.4	11	
M4	55	57	59.4	61.6	63.8	66	70.4	74.8							2.6	4.4	4.4	5.5	7.7	4.4	11	
C4	35	37	39.6	41.8	44	46.2	50.6	55							2.6	4.4	4.4	5.5	7.7			
N4	59	62	63.8	66	68.2	70.4	74.8	79.2							2.6	4.4	4.4	5.5	7.7			
T4	44	46	48.4	50.6	52.8	55	59.4	63.8							2.6	4.4	4.4	5.5	7.7	4.4	11	
Y5	20	28	35.2	42.9	50.6	58.3	73.7	89.1							5.5				13.2	4.4	11	
A5	64	72	79.2	86.9	94.6	102	118	133							5.5	11	4.4	5.5	7.7	4.4	11	
M5	62	69	77	84.7	92.4	100	116	131							5.5	4.4	4.4	5.5	7.7	4.4	11	
C5	68	96	83.6	91.3	99	107	122	138							5.5	4.4	4.4	5.5	7.7			
N5	66	74	81.4	89.1	96.8	105	120	135							5.5	11	4.4	5.5	7.7			
T5	51	58	66	71.5	81.4	89.1	105	120							5.5	4.4	4.4	5.5	7.7	4.4	11	
Y6		73		91.3		110	129	147	166	185	204	222	241		22						4.4	11
A6		117		135		154	173	191	210	229	248	266	285		22	11	4.4	5.5	7.7	4.4	11	
M6		141		160		178	197	216	234	253	272	290	309		22	11	4.4	5.5	7.7	4.4	11	
C6		123		142		161	179	198	217	235	254	273	292		22	11	4.4	5.5	7.7			
N6		147		166		185	204	222	241	260	278	297	316		22	11	4.4	5.5	7.7			
T6		139		157		176	195	213	232	251	270	288	307		22	11	4.4	5.5	7.7	4.4	11	
Y7		152		174		196	218	240	262	284	306	328	350		22						4.4	11
A7		196		218		240	262	284	306	328	350	372	394		22	13.2	4.4	5.5	7.7	4.4	11	
M7		238		260		282	304	326	348	370	392	414	436		22	11	4.4	5.5	7.7	4.4	11	
C7		202		224		246	268	290	312	334	356	378	400		22	13.2	4.4	5.5	7.7			
N7		244		266		288	310	332	354	376	398	420	442		22	11	4.4	5.5	7.7			
T7		235		257		279	301	323	345	367	389	411	433		22	11	4.4	5.5	7.7	4.4	11	
Y8		279		310		341	372	403	433	464	495	526	557		33	11	4.4	5.5	7.7	4.4	11	
M8		381		411		442	473	504	535	565	596	627	658		33	11	4.4	5.5	7.7	4.4	11	
T8		392		422		442	484	515	546	576	607	638	669		33	11	4.4	5.5	7.7	4.4	11	
K1T9					1010			1320			1716		1980	2310	92		4.4	5.5	7.7			
K1T10					1540			1716			2024		2156	2464	176		4.4	5.5	7.7			
K1T11					2200			2464			2992		3300	3784	312		4.4	5.5	7.7			